

前視圖

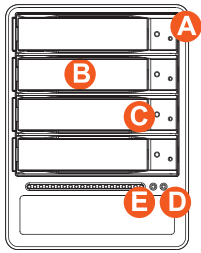

背視圖

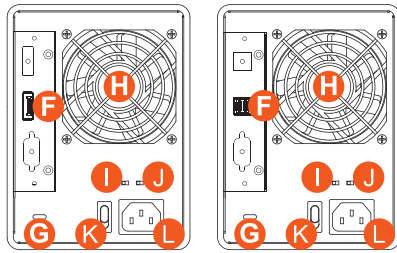

ST4-U5+

ST4-U6

- A 硬碟讀取燈
- B 硬碟抽取盒把手
- C 硬碟抽取盒鑰匙孔
- D 電源指示燈
- E 系統指示燈
- F Mini-SAS 連接埠
- G 防竊鎖孔
- H 風扇
- I 風扇轉速切換按鈕 (預設為高轉速)
- J 靜音開關
- K 電源開關
- L 電源插座

本產品是採用低噪音的電源供應器，當通電時的負載未達50%，電源供應器的風扇會暫停轉動。

V1.2 (Jan. 2018)

1

硬體安裝

請參照以下步驟完成硬體安裝：

- 當你打開包裝後，請先檢查產品主體以及附件是不是有毀損或是短缺情形，如果發生產品主體及附件短缺，請立刻與您的供應商聯絡。
- 將主機置放於平穩空間上，並確認散熱風扇沒有被擋住，且四周有適當的散熱空間。(請避免接近水源或是其他容易造成產品損傷的環境)
- 請使用零件包中所附的頂針插入鑰匙孔，開啟硬碟抽取盒把手將抽取盒取出。
- 將硬碟安裝到抽取盒上，並以零件包內附的螺絲加以固定，以避免不必要的移動對硬碟造成傷害。

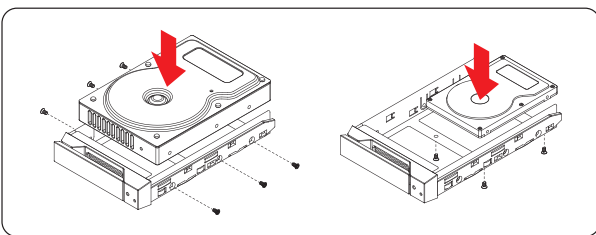

注意：不建議使用不同廠牌，或是同廠牌不同型號的硬碟，避免影響效能。

- 硬碟安裝完成後，請將抽取盒平移放入主機內，並關上把手。
- 請依據您欲使用的介面，從附件包中選擇相對應的連接線，將 ST4 SAS 系列背面連接埠與電腦主機相對應介面埠連接。
- AC Power 電源線與 ST4 SAS 系列主機連接好，並將接頭接上電源插座後開機。
- 開機後，您的作業系統將會自動辨識到儲存容量；待辨識成功後，請依據您所需的儲存格式，將系統依照作業系統的指示完成格式化。待磁盤格式化完成後，便可直接使用 ST4 SAS 系統。

3

打開包裝外盒後，包裝內容應包含下列組件：

產品配件表



ST4 SAS 系列
主體 x1



快速安裝
導引 x1



螺絲及鑰匙



電源線 x1



Mini-SAS 連接線(6G) x1
for ST4-U5+



Mini-SAS 連接線(12G) x1
for ST4-U6

- 請先確認相關配件與產品本身是否有受損或是缺少配件，若有任何疑問，請與您的經銷商或業務人員聯絡。
- 請前往官網-產品資料下載頁面 (<http://www.stardom.com.tw/STARDOM2016/download.php>) 下載驅動程式以及其餘相關資源。

燈號說明

| 狀態 | 電源指示燈 | 系統指示燈 | 硬碟狀態燈 | 蜂鳴器 |
|------|-------|-------|-------|-----|
| 無硬碟 | 藍燈恆亮 | —— | 紫燈恆亮 | —— |
| 硬碟故障 | 藍燈恆亮 | 紅燈閃爍 | 紫燈恆亮 | YES |
| 資料存取 | 藍燈恆亮 | —— | 藍燈閃爍 | —— |
| 硬碟閒置 | 藍燈恆亮 | —— | 藍燈恆亮 | —— |
| 風扇故障 | 藍燈恆亮 | 紅燈閃爍 | 藍燈恆亮 | YES |
| 過熱 | 藍燈恆亮 | 紅燈閃爍 | 藍燈恆亮 | YES |

2

產品使用注意事項

- ST4 SAS 系列可以同時安裝不同型號以及容量的四顆硬碟，如果 4 顆硬碟沒有全部安裝也可以使用，之後再隨個人需求增加硬碟的數量。
- 在 ST4 SAS 系列允許裝載使用 SAS 或 SATA 硬碟下，還是建議您先確認您所使用的 Mini-SAS 擴充卡是否有向下兼容 SATA 硬碟；另外，其系統處理效能表現將依 Mini-SAS 或 SATA 硬碟而異。
- 在安裝新硬碟到 ST4 SAS 系列之前，請先確認硬碟是沒有壞軌而且是沒有故障的，以避免資料受損。
- 當您需要關閉或移除 ST4 SAS 系列時，務必透過您所操作的作業系統中執行硬碟安全移除後，方可進行電源關閉的動作。
- 當系統運作時，請勿任意移除任何一顆硬碟，以免導致資料遺失。
- 如你希望將 ST4 系列搭配軟體或硬體 RAID 功能使用時，請先瞭解並注意你所要使用 RAID 層次及配件的特性與限制。
- 強烈建議除了使用 ST4 SAS 系列的資料儲存功能外，請針對重要資料備份到另一個儲存裝置上或遠端備份，雙重備份您重要的資料。若您儲存在 ST4 SAS 系列的資料損毀或遺失，STARDOM 將不負任何的責任。

感謝您使用 銳鉸科技股份有限公司 的產品。

本手冊裡的資訊在出版前雖然已經被詳細確認，但實際產品規格將已出貨時為準；任何的產品規格或相關資訊更新，請您直接上 www.STARDOM.com.tw 網站查詢，或直接與您的業務聯絡窗口聯繫，本公司將不另行通知。

如果您對 銳鉸科技 的產品有任何疑問，或是想獲得最新產品訊息、使用手冊或軟體，請您聯絡 services@stardom.com.tw，我們將儘速回覆您。

本說明相關產品內容歸 銳鉸科技股份有限公司 版權所有

4

ST4 SAS Series Quick Setup Guide

Product Illustration and Parts List

Front View

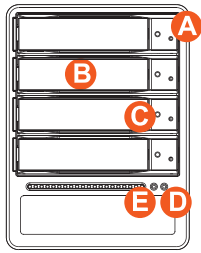

Rear View

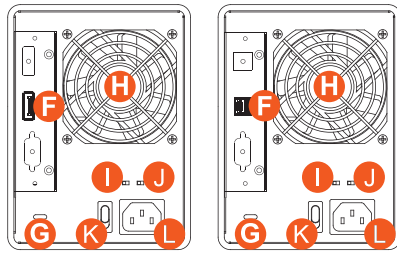

ST4-U5+

ST4-U6

- A** HDD access light
- B** HDD enclosure handle
- C** HDD enclosure keyhole
- D** Power status light
- E** System status light
- F** Mini-SAS port
- G** Anti-theft lock
- H** Fan
- I** Fan speed switch (set to "High" by default)
- J** Mute switch
- K** Power switch
- L** Power socket

This product uses a low-noise Switching Power Supply. Its built-in fan will temporarily stop while the total power consumption is below 50% of the full load.

V1.2 (Jan. 2018)

1

The following items should be inside the package upon opening:

Product Parts List



ST4 SAS Series body x1



Quick Setup Guide x1



Screws and keys



Power Cord x1



Mini-SAS cable (6G) x1
for ST4-U5+



Mini-SAS cable (12G) x1
for ST4-U6

- Please check the product and accessories for any defect or missing parts. If you have any questions, please contact your product supplier.
- Please visit the official website - Download page (<https://www.stardom.com.tw/STARDOM2016/download.php>) to download drivers and other related resources.

The Indication of HDD Status

| Status | Power Status Light | System Status light | HDD Status Light | Buzzer |
|-----------------|-------------------------|-----------------------|---------------------------|--------|
| No HDD detected | Blue light Always on | --- | Purple light Always on | --- |
| HDD failure | Blue light Always on | Red light Flashing | Purple light Always on | YES |
| Data access | Blue light Always on | --- | Blue light Flashing | --- |
| HDD idle | Blue light Always on | --- | Blue light Always on | --- |
| Fan failure | Blue light Always on | Red light Flashing | Blue light Always on | YES |
| Overheat | Blue light Always on | Red light Flashing | Blue light Always on | YES |

2

Hardware Installation

Please follow the steps below to complete the ST4 SAS Series hardware setup process:

1. When you open the package, please immediately check the product and included parts for any damage or missing parts. If there is a problem with the product or included parts please contact your supplier immediately.
2. Place the device on a flat, even surface. Make sure that the cooling fan is not blocked and there is sufficient surrounding space for cooling. (Keep away from water or other environments that may cause product damage).
3. Please insert the pin included with the parts pack into the keyhole to release the HDD enclosure handle and remove the HDD enclosure.
4. Place the hard disk in the HDD enclosure and secure it in place with the included screws; this will prevent damage to the hard disk from external vibration.

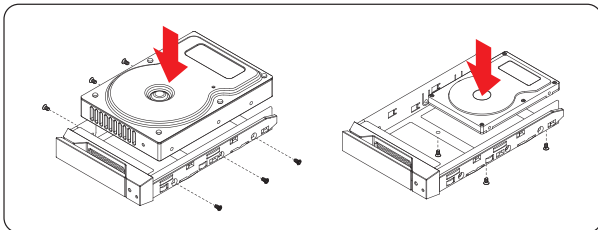

Note: Please avoid using hard disk drives from different manufacturers or different models from the same manufacturer as this may impact system performance.

5. Once the hard disk is installed, slide the enclosure into the system and close the handle.
6. Select the appropriate cable from the accessories pack depending on the interface. Connect the ST4 SAS Series backplate connection port to the corresponding port on the computer.
7. Connect the AC Power cable to the ST4 SAS Series. Plug the connector into the power socket then start the system.
8. Your operating system will automatically detect available capacity once the device finishes booting. Once the device has been detected, please follow instructions given by the operating system and format the system. Once the hard disk has been formatted, the ST4 SAS Series system can be used.

3

Important Notice

1. The ST4 SAS Series allows you to install up to 4 hard drives of different models and capacities. They are not required to simultaneously have all 4 hard drives installed in order for the system unit to operate. You may use one first and add more drives later accordingly to your preference.
2. Although ST4 SAS Series allows you to install either SAS or SATA drives, it is recommended to check whether the mini-SAS host adapter you're using is downward compatible with SATA drives. Also note that the throughput performance may vary if SAS and SATA drive are installed.
3. Please make sure that the hard drives are free from bad blocks or defects prior to installation in order to avoid system crashes or data loss.
4. Whenever turning off or unplugging the ST4 SAS Series from your computer system becomes necessary, always remember to safely remove it from your operating system first.
5. When the ST4 SAS Series is connected to the computer system, it's prohibited to remove, insert or swap the hard drive while data transfer is being performed.
6. If you will be incorporating either software or hardware RAID functionality to operate with the ST4 SAS Series, it is important to understand the RAID level and its component that will be incorporated and the precautions to take as each RAID level and component may function differently and contains various limitations.
7. It is highly recommended for users to back up important data contained within the drives of the ST4 SAS Series on a regular basis or whenever the user feels necessary to a remote or a separate storage device. STARDOM will not be responsible for any loss of data caused during the use of the ST4 SAS Series or the recovery of the data lost.

Thank you for choosing this RAIDON product.

The information provided in this manual was checked before publication, but the actual product specifications may have changed before shipping; Latest product specifications and updates can be found at www.STARDOM.com.tw or through your sales representative. No separate notifications will be provided by our company.

If you have any questions about RAIDON products or would like to receive the latest product information, instruction manuals, or firmware, please contact services@stardom.com.tw for assistance.

All product-related content in this manual are copyrighted by RAIDON TECHNOLOGY, INC.

4